



switchDin

Quick Reference Guide

Droplet + Fimer for Flexible Exports (SA)

For SA Power Networks
Flexible Exports

Prepared by:

SwitchDin Pty Ltd
91 Parry Street
Newcastle West 2302

1. Required Hardware & Software Checklist

* Accessory Board UNO-DM-PLUS-COM Ethernet KIT required

- UNO-DM-TL-PLUS-Q 3.3-6.0kW
- Any compatible meter
- SwitchDin Residential Droplet
- GPO for SwitchDin Droplet
- Sets of cables – ethernet & ethernet to USB converter
- RS485 to USB converter (for Eastron Meter)
- SwitchDin App
www.switchdin.com/app



2. Onsite, wire up Eastron Meter on grid or load configuration. Refer [OTR Wiring Information and Diagram](#)

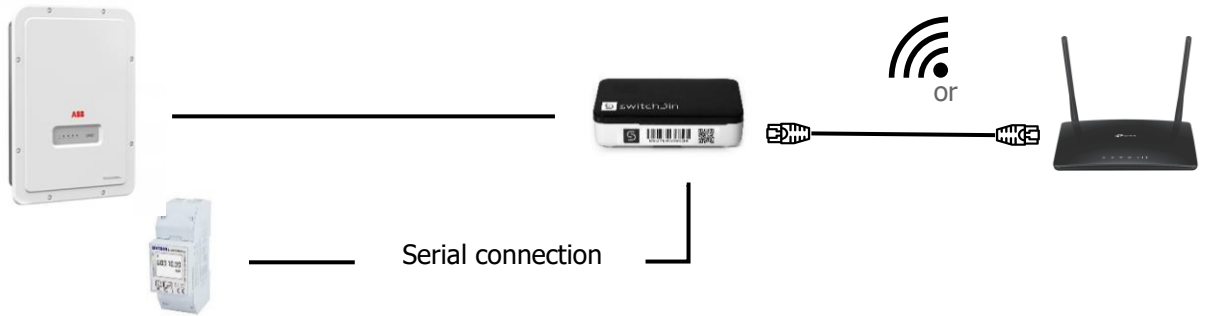

- Refer to the relevant Eastron manual for Modbus serial connection (eg [SDM230 series](#))
- Refer section 4 for more information on Droplet compatible serial to USB converters

3. Fimer Inverter Settings

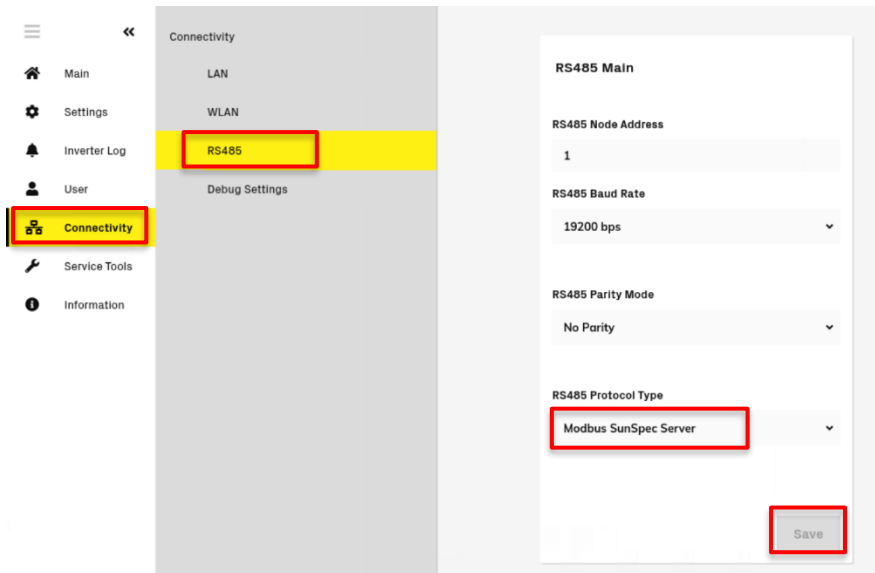

1. Select "Connectivity" in the side menu
2. Select "RS485"
3. Change the "RS485 Protocol Type" to "Modbus SunSpec Server" and click "Save"

4. Wiring the inverter / meter to the droplet

Inverter to Droplet

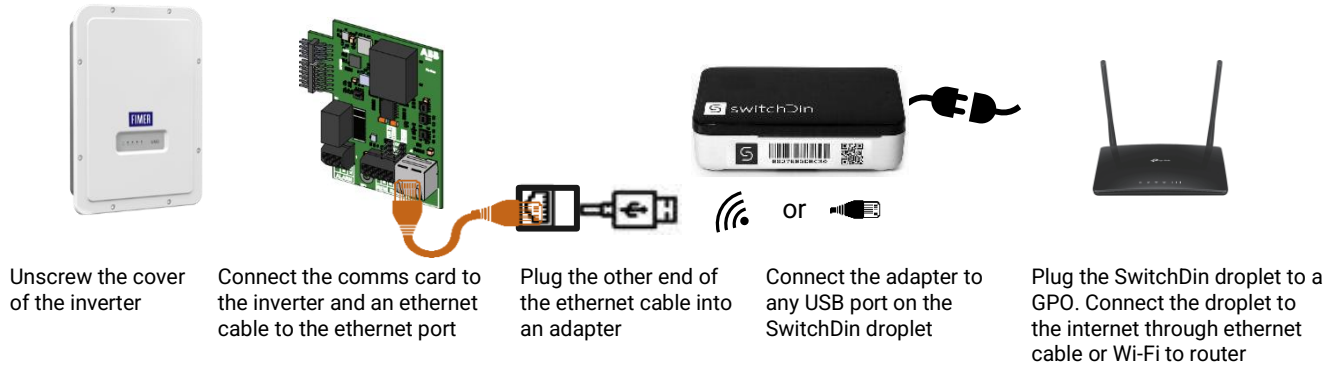

Fimer comms card guide: [UNO-DM-COM KIT & UNO-DM-PLUS Ethernet COM KIT-Quick Installation Guide EN-RevC.pdf \(fimer.com\)](https://www.fimer.com/UNO-DM-COM%20KIT%20&%20UNO-DM-PLUS%20Ethernet%20COM%20KIT-Quick%20Installation%20Guide%20EN-RevC.pdf)

Eastron Meter: Eastron RJ45 cable + RS485 to USB converter

1. Use the cable provided by Eastron meter
2. Match and connect the pin between the Eastron Meter and the RS485 to USB converter.

DB9	Output Signal	Full Duplex connection	Half-Duplex connection
1	T/R+	TXD(A+)	RS485(A+)
2	T/R-	TXD(B-)	RS485(B-)

3. Connect the USB adaptor to any of the USB ports on the droplet

Examples of RS485 to USB converter



DTECH 0.5m USB to RS422 RS485 Serial Port Converter



USB Port to RS-485/422 Converter



Industrial USB to RS485 Converter

5. Commissioning

5.1 Commission the inverter:

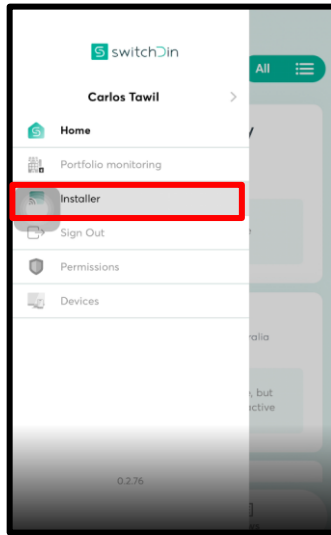

1. In the Installer app, select installer from the side menu, the scanner will start
2. Scan the QR code on the side of the droplet, follow the prompts and select to connect via ethernet or Wi-Fi

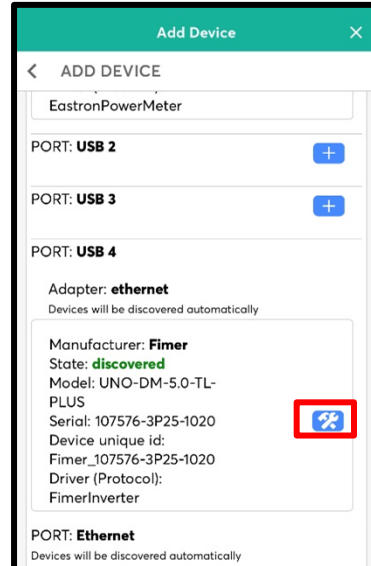

3. Add a device by clicking the "+" icon on the bottom right of the screen
4. Select the discovery option.
5. Click the configuration button for the inverter, the message "Configured" appears

5.2 Eastron Meter

Complete the following steps to configure the meter.



6. Click "+" on the USB port number where the meter comms cable is connected.
7. Then select "Eastron" from the device list.

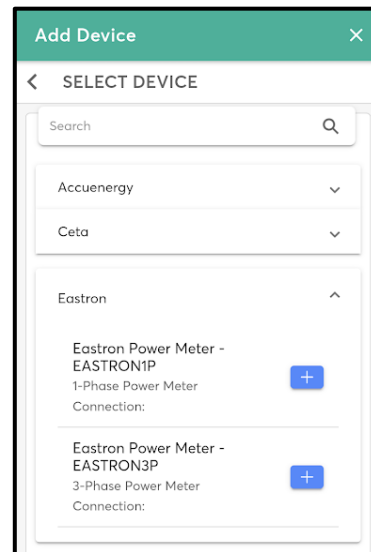

8. Select the correct Eastron meter for your installation (single or three-phase)
9. Click back in the top left corner

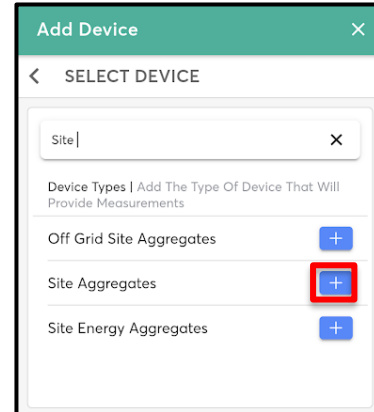
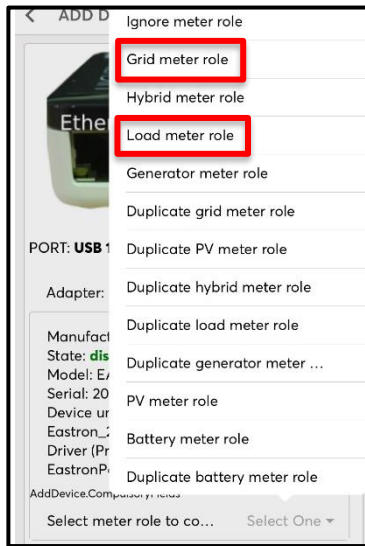

ONLY FOR LOAD/ CONSUMPTION PATH

10. Click the “Select meter role to con...” drop down and select “Grid meter role” or “Load meter role”
11. Click the configure button (blue hammer and spanner)
12. Click back on the top left corner and select “Manual” discovery
13. Search “Site Aggregates”, and click ‘+’

5.3 Register device for flexible exports:

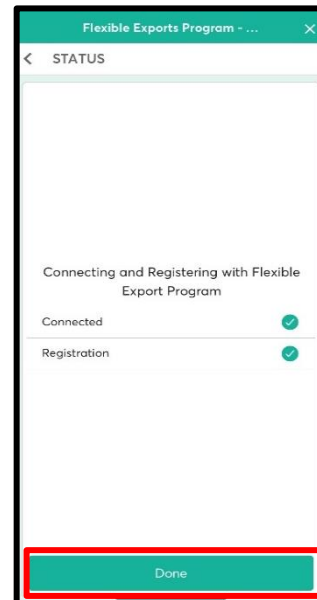
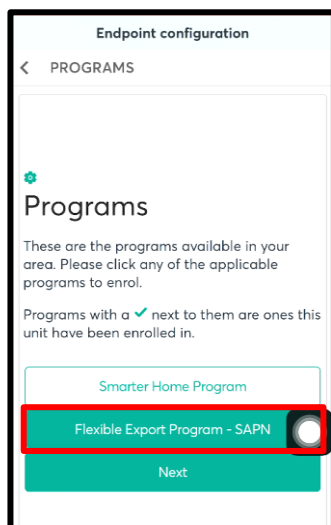

1. Close the “Add device” window, click next.
2. Select the option “Flexible Exports Program – SAPN”
3. Enter NMI, click next
4. The screen indicates if the connection and registration is successful. Click done

6. Troubleshooting

1. Droplet status indicator meanings



	Indication	Red	Green	Blue
PWR	Power	N/A	Power	N/A
WiFi	WiFi	No Wi-Fi	Wi-Fi connected	Weak Wi-Fi signal
iNet	Internet	No Internet	Internet connected	Configure via SwitchDin app
SDin	SwitchDin comms	Cannot see SwitchDin	Connected to SwitchDin	N/A
Devs	Devices attached	No devices	Devices detected	N/A

2. [SwitchDin Installation video](#):

Warranty claims & support: support@switchdin.com

General enquiries: info@switchdin.com,

Support: +61 (0) 2 4786 0426